

FontanaArte

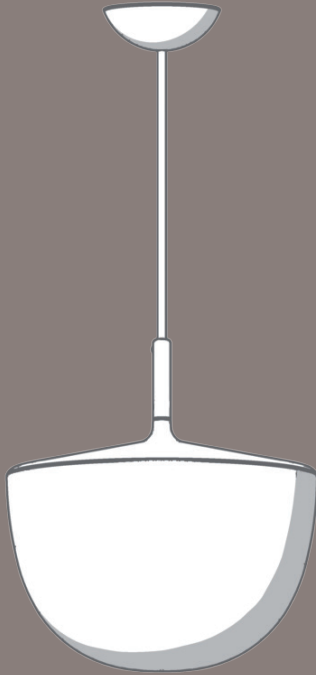

Cheshire
by GamFratesi

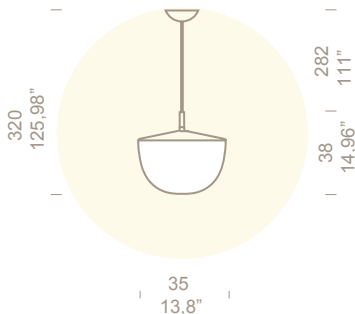

Classe II



IP40

cod. 4316 (220V - 50 Hz)

17,5 W LED

CRI > 80 - 2700 K

Ø 35 × 38 + 282 max

cod. U4316 (110V - 60Hz)

17,5 W LED

CRI > 80 - 2700 K

Ø 13,8" x 14,96" + 111"

by GamFratesi, 2013

FontanaArte spa
Alzaia Trieste, 49
I-20094 Corsico (MI), Italia
Ph. +39 02 45121
Fax +39 02 4512660/990
www.fontanaarte.com
info@fontanaarte.com

cod. 009431601



cod. 4316

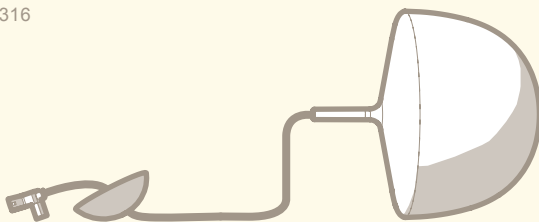

2x



2x



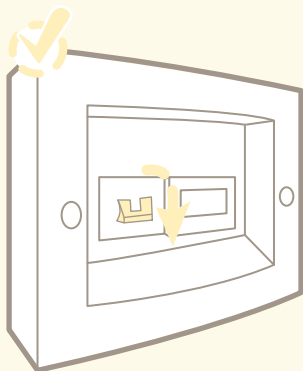

1

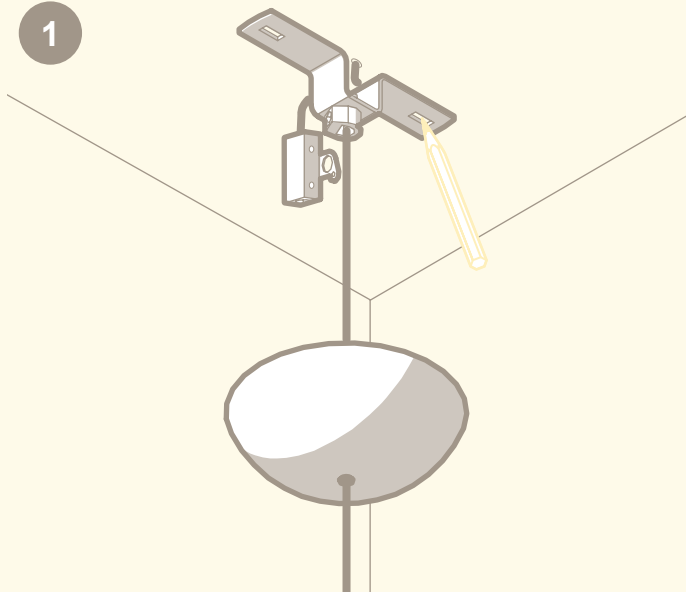

2

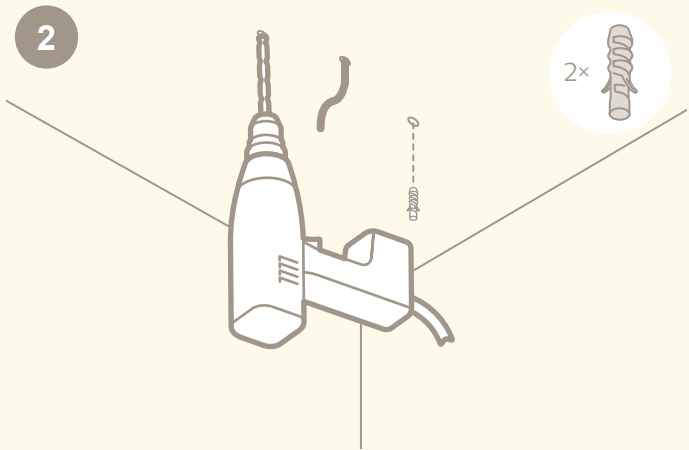

3

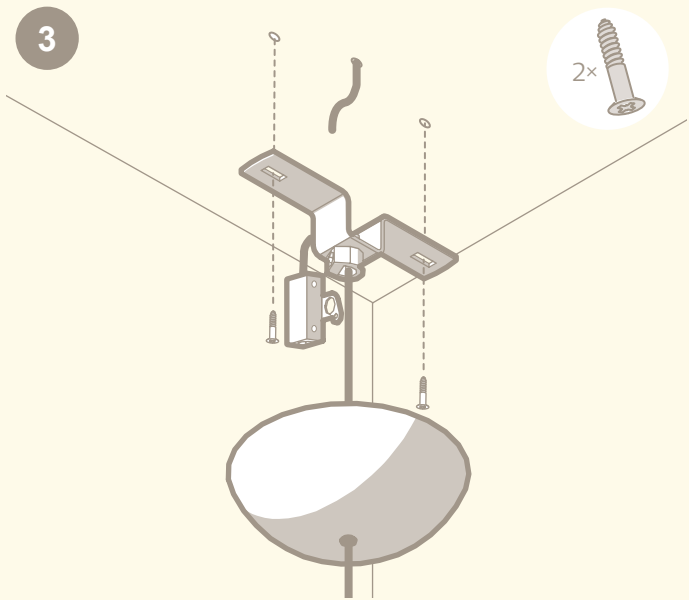

4

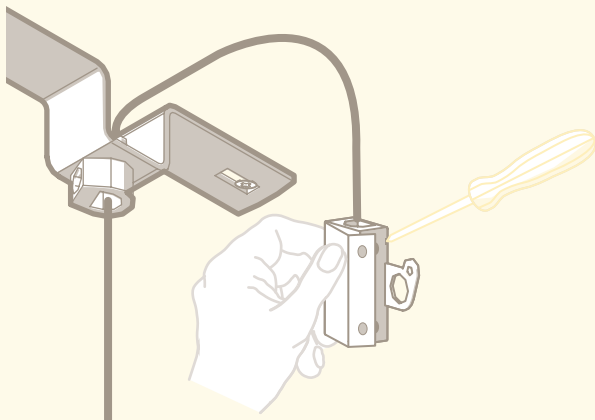

5

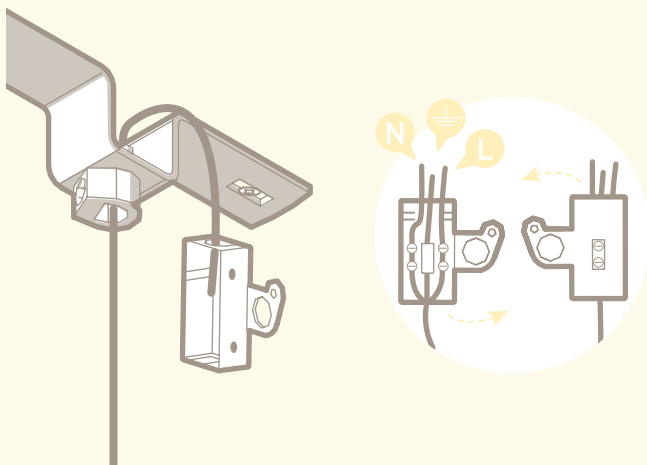

6

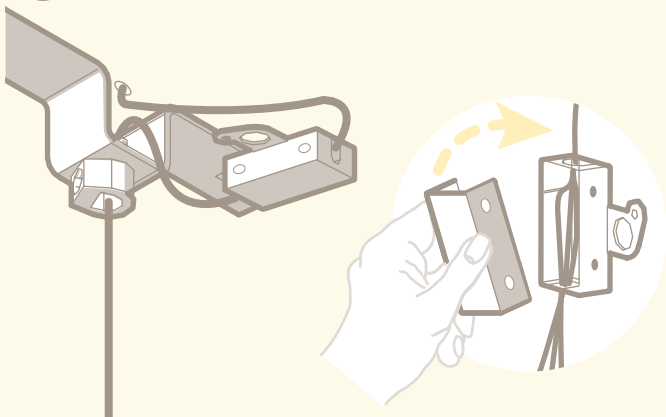

7

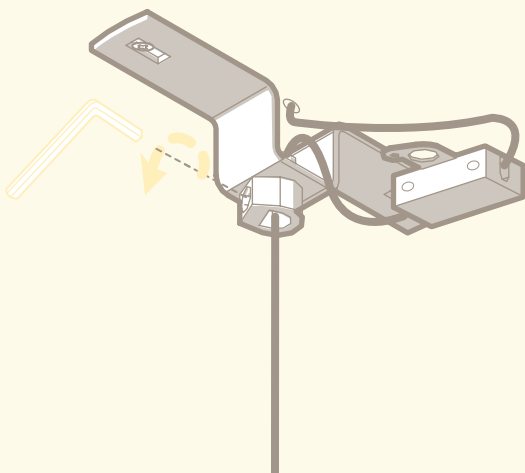

8

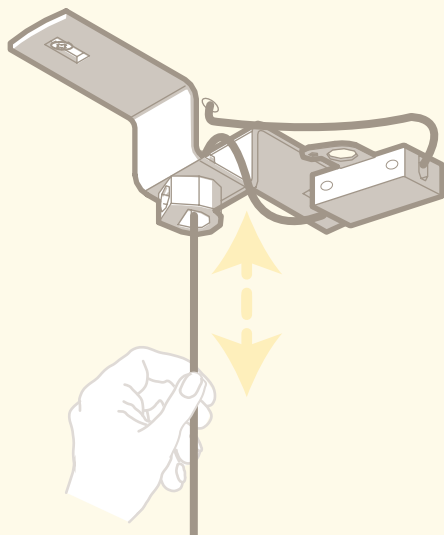

9

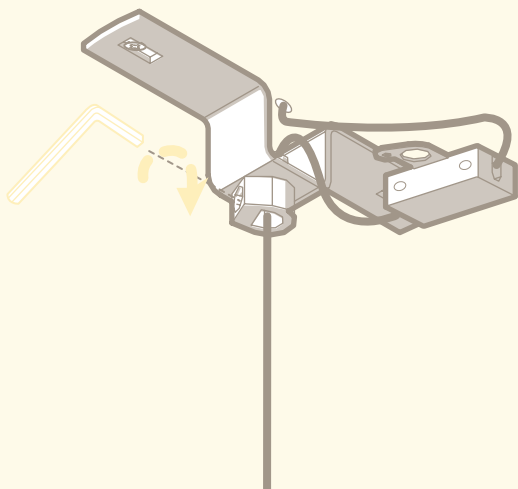

10

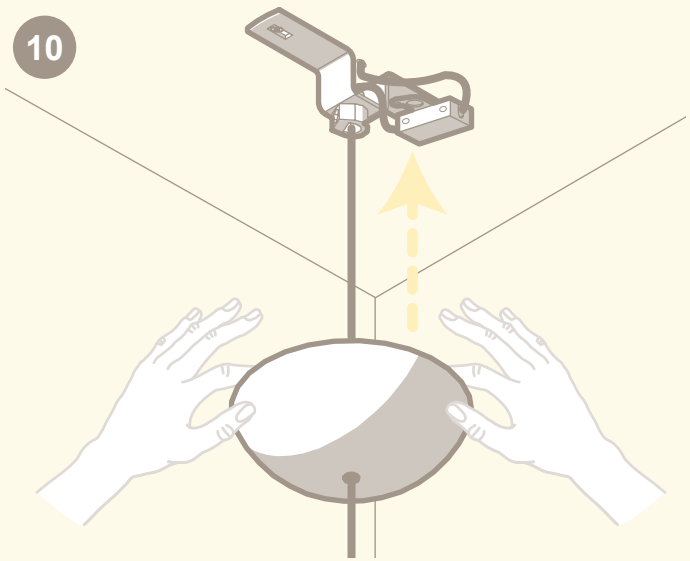

11

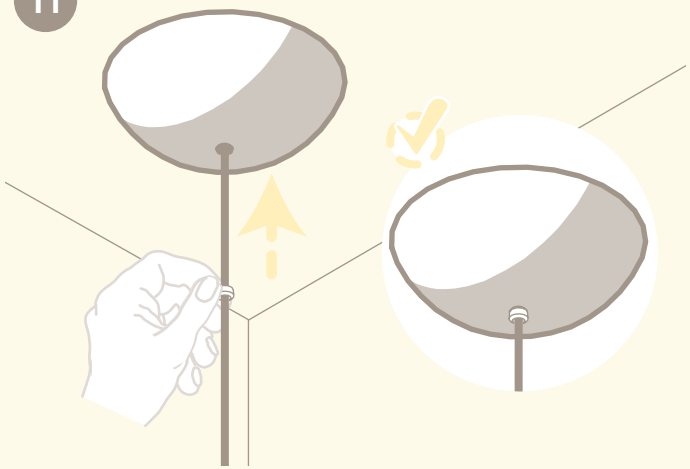

12





cod. U4316

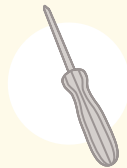
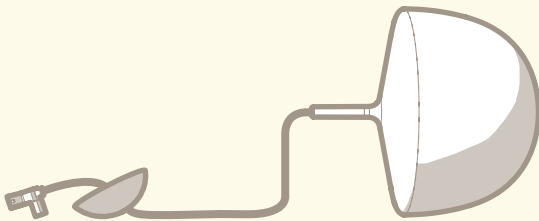

1

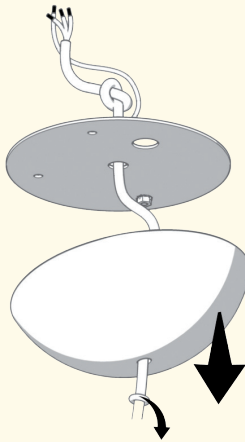

2

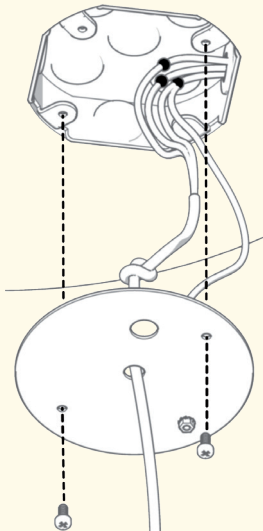

3

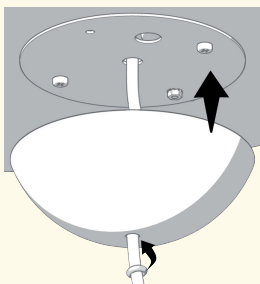

cod. 4316
cod. U4316

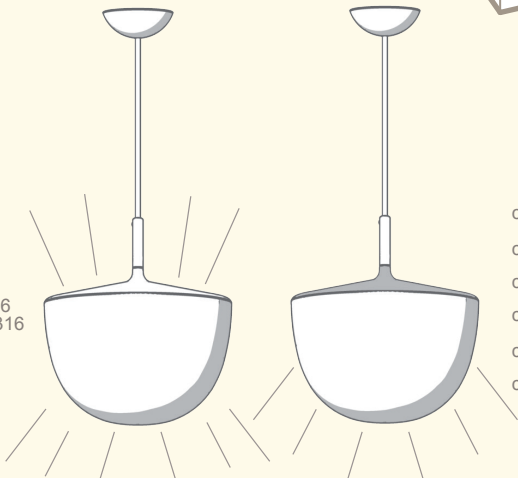

cod.4316BI ○

cod.4316N ●

cod.4316V ●

cod.U4316BI ○

cod.U4316N ●

cod.U4316V ●

I cherish my home because
it's where **love** dwells.
A full house needs an
honest light.

FontanaArte

Lights to live

www.fontanaarte.com